

Phase 3: Bridge Assembly, Crane Assembly and Bridge Lift	
This information is indicative only, for details refer to the outline Construction Environmental Management Plan, Volume 3, Appendix 3-1 of the EIA/EIS	
Activities	Bridge Assembly, Main Crane Assembly Bridge Lift
Materials	Construction Waste, Aggregates, geotextiles, geogrids, sheet piles (if applicable)
Plant	Standard Construction Plant (Excavator, dumpers etc) <ul style="list-style-type: none"> <li>• Delivery Lorries</li> <li>• Service Crane (Type TBC) 200-300T approx.</li> <li>• Main Crane A1680 1200T approx.</li> <li>• Ballast - approx. 300T</li> <li>• Outriggers approx. 14.5m x 14.5m</li> <li>• Lorries delivering bridge in pre-fabricated sections for assembly.</li> </ul>
Environmental Considerations	River Foyle SAC, biodiversity, traffic management, flood risk
General Environmental Mitigation Measures	<ul style="list-style-type: none"> <li>• double skinned fuel bowers only to be used.</li> <li>• bowers to be locked at all times during transport, with access to the fuel controlled by the site manager.</li> <li>• bowers shall be brought into the buffer zone as and when required for refuelling of static plant only (cranes and piling rigs) and removed immediately to the construction compound thereafter.</li> <li>• No fuel / oil bowers shall be stored within the buffer zone.</li> <li>• diesel bowers to be locked at all times</li> <li>• spill kits to be retained on site at all times</li> <li>• drip trays to be provided when required</li> <li>• wastage to be discarded appropriately in skips or bins provided</li> <li>• plant to be inspected for hydraulic leaks prior to commencement</li> <li>• designated concrete washout areas to be used as advised by Main Contractor</li> <li>• Ensure tracks are clean and any loose debris is cleaned off the road</li> <li>• It is permissible to undertake emergency repairs and essential maintenance of static plant, whilst positioned in the buffer zone, provided all appropriate oil spill prevention and clean-up measures are in place, including deployment of plant nappies under any works and spill kits are available at close quarters within the buffer zone.</li> </ul>
Environmental Mitigation Measures	<ul style="list-style-type: none"> <li>• All works within the SAC to be completed within May to September to mitigate ecological risk.</li> <li>• Permanent Piles are prohibited within the watercourse</li> <li>• Contractor to Provide and Implement Flood Management Plan</li> <li>• Works to be completed under the supervision of an Ecological Clerk of Works</li> </ul>

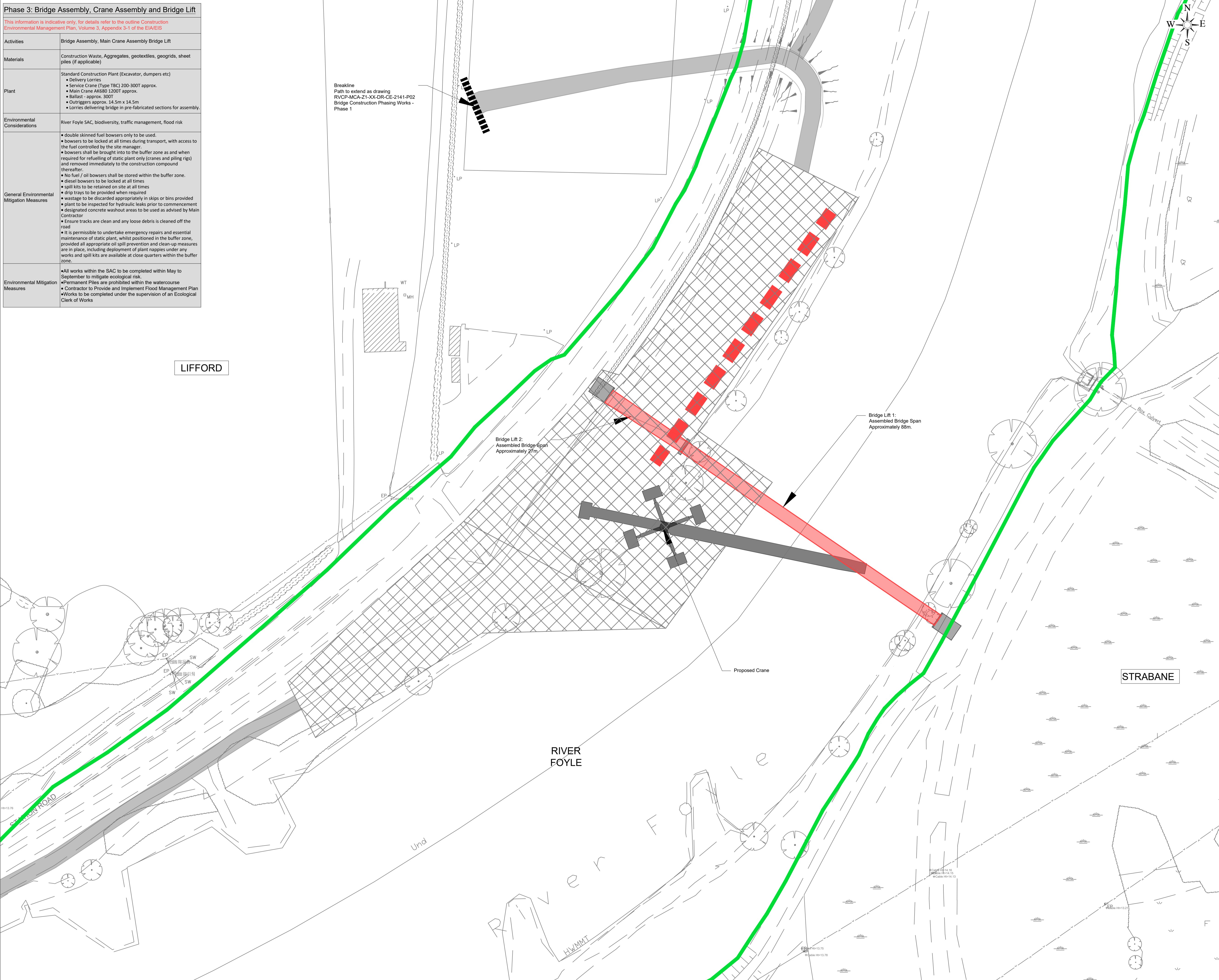

- NOTES**
- All measurements shown are in metres, and all levels are to ordnance datum unless otherwise indicated
  - All Coordinates are to Irish Grid (TM65), unless otherwise noted.
- LEGEND**
- Crane & Bridge Assembly Working Area
  - Proposed Crane
  - Proposed Access Road
  - Bridge Sections for Assembly on Site
  - Assembled Bridge
  - SAC Boundary

Based upon Land and Property Services data with the permission of the controller of Her Majesty's Stationery Office, © Crown copyright and database rights (CS&LA 581)  
 Ordnance Survey Ireland mapping data used with permission: in association with Donegal County Council - OS License 2003/07/CCMA/Donegal County Council.  
 Copyright Ordnance Survey Ireland, Government of Ireland.

P02	21/04/2022	ABPFI Platform Area Amended	P McM
Rev	Issue Date	Description	App

Quantity Surveyors

**Sammon**

Sammon  
 9-11 Corporation Square  
 Belfast, BT1 3AJ

T 028 7127 1323  
 info@sammon.eu  
 www.sammon.eu

Landscape Architects

**the paul hogarth company**

The Paul Hogarth Company Ltd  
 Potter's Quay, 5 Ravenhill Road  
 Belfast, BT6 8DN

T 028 9073 6690  
 belfast@paulhogarth.com  
 www.PaulHogarth.com

Project Manager, Civil & Structural Engineers

**McAdam**  
 ENHANCING LOCAL COMMUNITIES

1c Montgomery House  
 478 Castlereagh Road  
 Belfast, BT5 6BQ

T: 028 9040 2000  
 E: admin@mcadamdesign.co.uk  
 www.mcadamdesign.co.uk

Funder

**Peace**  
 Northern Ireland - Ireland  
 European Regional Development Fund

Client

**Comhairle Contae Dhún na nGall**  
 Donegal County Council

Derry City & Strabane District Council  
 Comhairle Chathair Dhóire & Cheantar an tSráidh Balaí  
 Derry City & Strabane District Council

Project Status

**STAGE 3 - PLANNING**

Project

**RIVERINE COMMUNITY PARK**

Drawing

**BRIDGE CONSTRUCTION PHASING WORKS - PHASE 3**

Scale

**1:500 @ A1**

Drawn	CR	Checked	DA	Approved	CM
Date	25/08/21	Date	25/08/21	Date	25/08/21

Project	Organisation	Zone	Level	Type	Role	Number	Revision
RVCP	MCA	Z1	XX	DR	CE	2143	P02

Project Number	Status code & Description
E2256	S2 - For Information

All dimensions are in metres. Figured dimensions to be taken in preference to scaled dimensions. Dimensions to be checked on site. © 2021 McAdam Design Ltd.